



**The Property Registration Authority**  
**An tÚdarás Clárúcháin Maoine**

Handwritten notes in red and blue ink: a signature, '6/9', and a circled '640'.

**Land Registry Sealed and Certified Copy Folio (& Filed Plan)**

NICHOLAS O'DWYER CONSULTING ENGINEERS  
NUTGROVE OFFICE PARK  
NUTGROVE AVENUE  
DUBLIN 14

**This page forms part of the official document. Do not detach.**

**Folio Number:** CK58009F  
**Application Number:** P2016LR068857W  
**Your Reference:** Cobh FLA

This document comprises an office copy of the Land Registry record for the above mentioned folio/filed plan as of the date appearing.

Details of **dealings pending** (if any) on the enclosed folio/filed plan are listed in the **Schedule** below.

*K. Maguire*

An officer duly authorised by the Property Registration Authority.

**Schedule**



**Notes:**

1. Filed plans should be read in conjunction with the Register. The description of the land in the Register or on the filed plan is not conclusive as to the boundaries or extent of the land (see Section 85 of the Registration of Title Act 1964, as substituted by Section 62 of the Registration of Deeds and Title Act, 2006).
2. Filed plans greater than A3 in size may be provided as separate A3 tiles with an overlap and print gutter. When aligning the tiled sheets, customers are advised to use the underlying topographical detail.
3. On receipt of this record, please check to verify that all the details contained therein are correct. If this is not the case, please return the document to the Property Registration Authority immediately.

**Land Registry**

**County Cork**

**Folio 58009F**

**Register of Ownership of Freehold Land**

**Part 1(A) - The Property**

Note: Unless a note to the contrary appears, neither the description of land in the register nor its identification by reference to the Registry Map is conclusive as to boundaries or extent

No.	For parts transferred see Part 1(B) Description	Official Notes
1	<p>A plot of ground situate in the Town of Passage West being part of the Townland of MAULBAUN and Barony of Kerrycurrihy containing 1.1380 Hectares shown as Plan(s) 104, 103, 102, 99, 98, 97 edged RED on the Registry Map (OS MAP Ref(s) 6430/12, 6430/17).</p> <p>The Registration does not extend to the mines and minerals</p>	Instrument S 1742/91
2	<p>A plot of ground situate in the Town of Passage West being part of the Townland of LACKAROE and Barony of Kerrycurrihy containing .8160 Hectares shown as Plan(s) 35 edged RED on the Registry Map (OS MAP Ref(s) 6430/17, 6430/22).</p> <p>The Registration does not extend to the mines and minerals</p>	Instrument S 1742/91
3	<p>A plot of ground situate in the Town of Passage West being part of the Townland of MONKSTOWN and Barony of Kerrycurrihy containing .7620 Hectares shown as Plan(s) 320, 319, 318, 317, 316 edged RED on the Registry Map (OS MAP Ref(s) 6430/22, 6472/2, 6472/7).</p> <p>The Registration does not extend to the mines and minerals</p>	Instrument S 1742/91
Note: O.S. Reference amended see D2001CK011818G		
4	<p>A plot of ground situate in the Town of Passage West being part of the Townland of MONKSTOWN (CASTLE FARM) and Barony of Kerrycurrihy containing 11.3500 Hectares shown as Plan(s) 142 edged RED on the Registry Map (OS MAP Ref(s) 6472/7, 87/6, 87/10).</p> <p>The Registration does not extend to the mines and minerals</p>	Instrument S 1742/91
5	<p>A plot of ground situate in the Town of Passage West being part of the Townland of BALLYFOULOO and Barony of Kerrycurrihy containing 2.1360 Hectares shown as Plan(s) 101, 100 edged RED on the Registry Map (OS MAP Ref(s) 87/10).</p> <p>The Registration does not extend to the mines and minerals</p>	Instrument S 1742/91
Note: O.S. Reference amended see D2001CK011818G		

**Land Registry**

**County Cork**

**Folio 58009F**

**Part 1(B) - Property  
Parts Transferred**

No.	Prop No:	Instrument:	Date:	Area (Hectares):	Plan:	Folio No:
1	1	D2000CK004390E	04-APR-2000		A1YKQ A1YKR A1YKT 100 101	CK91623F

Land Registry

County Cork

Folio 58009F

Part 2 - Ownership

Title ABSOLUTE

No. The devolution of the property is subject to the provisions of Part II of the Succession Act, 1965

1 ~~05-AUG-1993~~ ~~THE COUNTY COUNCIL OF THE COUNTY OF CORK of COUNTY HALL, CORK~~  
~~S 1742/91~~ ~~is full owner.~~

Cancelled D2011LR125560V 09-NOV-2011

2 05-AUG-1993 Cork County Council, County Hall, Cork is full owner.  
D2011LR125560V

S 1742/91 Altered 09-NOV-2011 Instrument No. D2011LR125560V

**Land Registry**

**County Cork**

**Folio 58009F**

**Part 3 - Burdens and Notices of Burdens**

No.	Particulars
1	The property is subject to the provisions prohibiting letting, subletting or subdivision specified in Section 12 of the Land Act, 1965, and to the provisions restricting the vesting of interests specified in Section 45 of the said Act in so far as the said provisions affect same.
2	The property herein having been acquired by the Registered Owner thereof for its statutory purposes is subject to such restrictions against alienation or letting as may be contained in the Statutory Enactments relating to such property.

577340 mE, 568280 mN

The Property  
Registration Authority  
An tÚdarás  
Clárúcháin Maoine



Folio: CK58009F

This map should be read in conjunction with the folio.

Registry maps are based on OSi topographic mapping. Where registry maps are printed at a scale that is larger than the OSi published scale, accuracy is limited to that of the original OSi map scale.

For details of the terms of use and limitations as to scale, accuracy and other conditions relating to Land Registry maps, see [www.prai.ie](http://www.prai.ie).

This map incorporates Ordnance Survey Ireland (OSi) mapping data under a licence from OSi. Copyright © OSi and Government of Ireland.

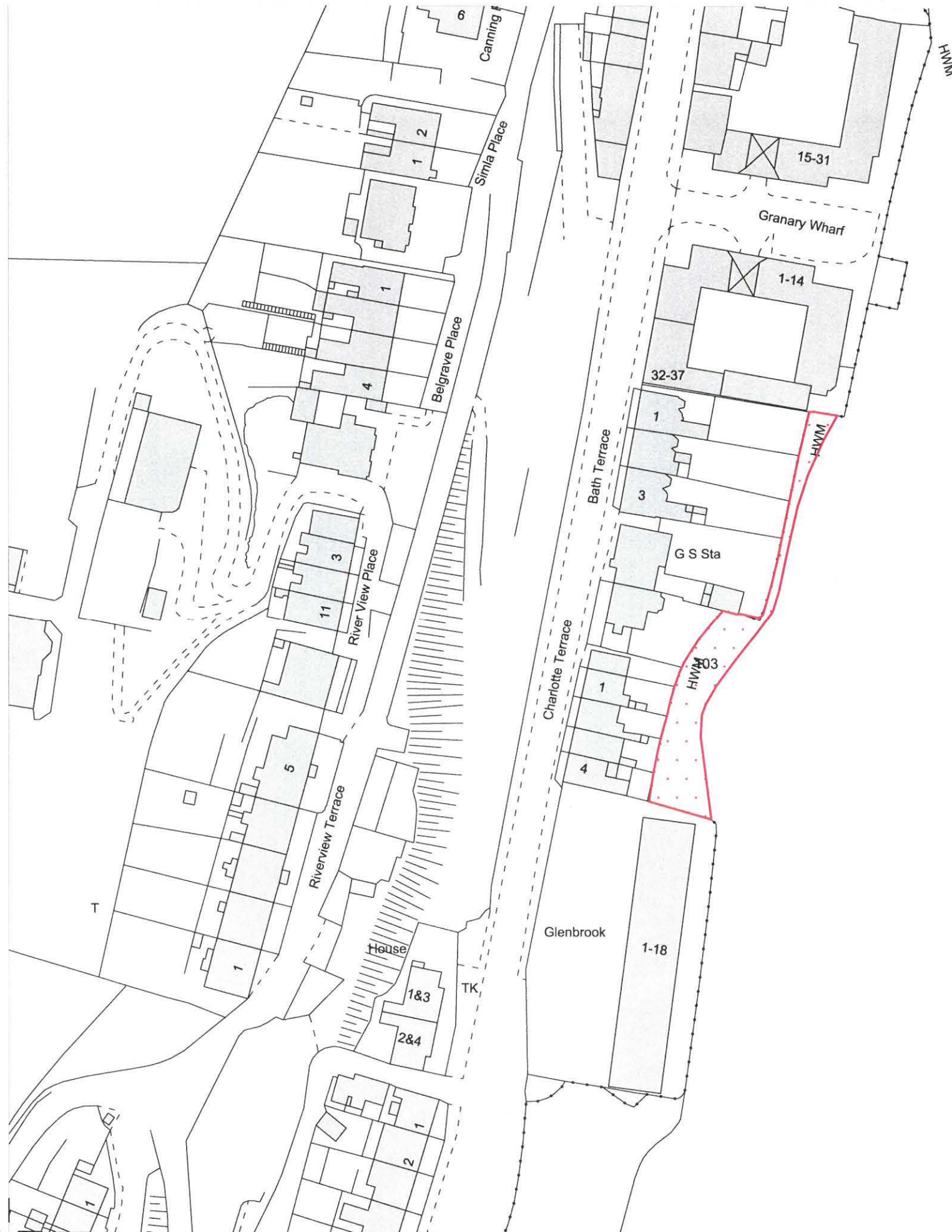

(centre-line of parcel(s) edged)

- Freehold
- Leasehold
- SubLeasehold

Burdens (may not all be represented on map)

- Right of Way / Wayleave
- Turbary
- Pipeline
- Well
- Pump
- Septic Tank
- ▽ Soak Pit



A full list of burdens and their symbology can be found at: [www.landdirect.ie](http://www.landdirect.ie)

The registry operates a non-conclusive boundary system. The Registry Map identifies properties not boundaries meaning neither the description of land in a register nor its identification by reference to a registry map is conclusive as to the boundaries or extent. (see Section 85 of the Registration of Title Act, 1964). As inserted by Section 62 of the Registration of Deed and Title Act 2006.



577280 mE, 568070 mN

The Property  
Registration Authority  
An tÚdarás  
Clárúcháin Maoine



Folio: CK58009F

This map should be read in conjunction with the folio.

Registry maps are based on OSi topographic mapping. Where registry maps are printed at a scale that is larger than the OSi published scale, accuracy is limited to that of the original OSi map scale.

For details of the terms of use and limitations as to scale, accuracy and other conditions relating to Land Registry maps, see [www.prai.ie](http://www.prai.ie).

This map incorporates Ordnance Survey Ireland (OSi) mapping data under a licence from OSi. Copyright © OSi and Government of Ireland.

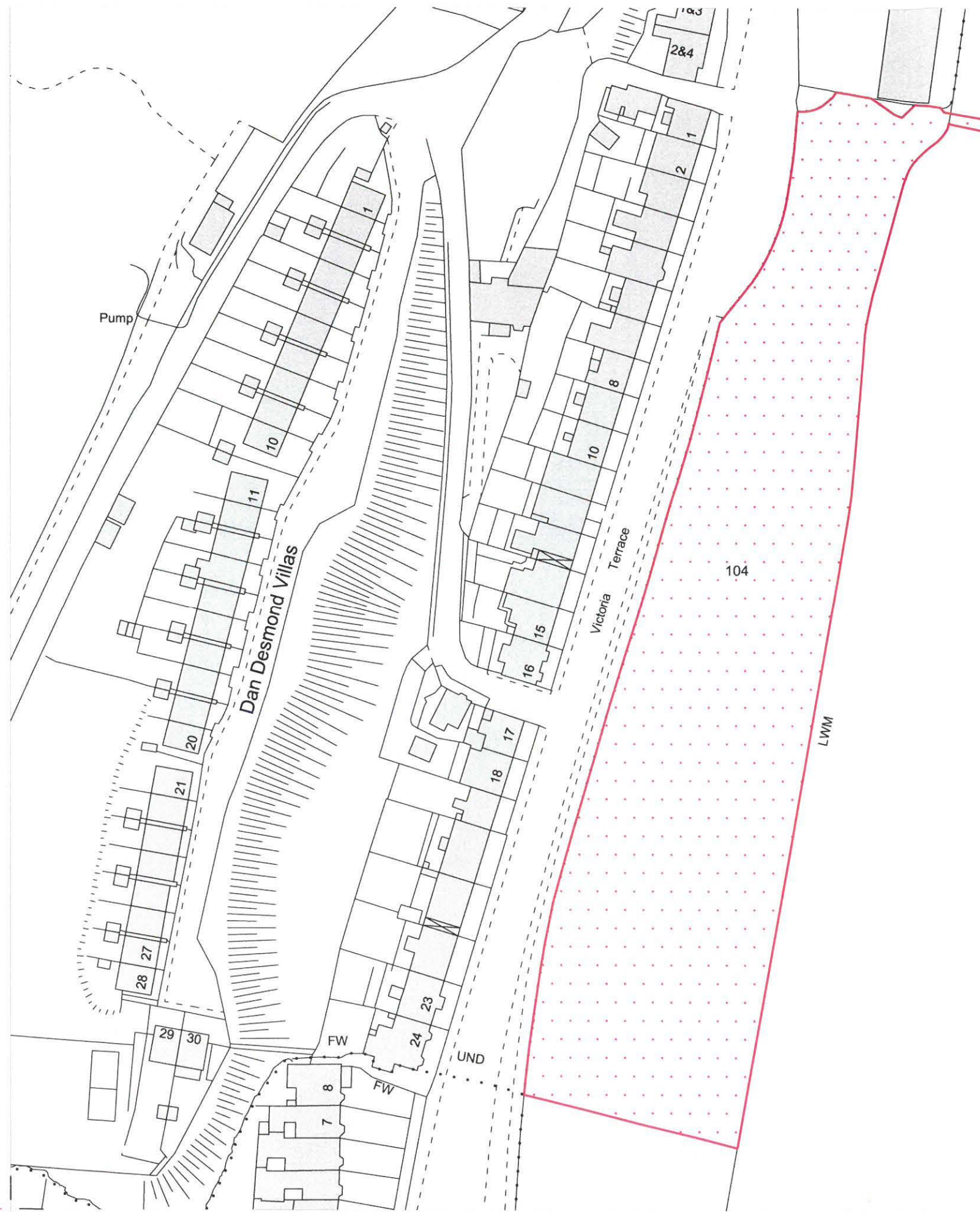

(centre-line of parcel(s) edged)

- Freehold
- Leasehold
- SubLeasehold

Burdens (may not all be represented on map)

- Right of Way / Wayleave
- Turbary
- Pipeline
- Well
- Pump
- Septic Tank
- ▽ Soak Pit

A full list of burdens and their symbology can be found at: [www.landdirect.ie](http://www.landdirect.ie)



The registry operates a non-conclusive boundary system. The Registry Map identifies properties not boundaries meaning neither the description of land in a register nor its identification by reference to a registry map is conclusive as to the boundaries or extent. (see Section 85 of the Registration of Title Act, 1964). As inserted by Section 62 of the Registration of Deed and Title Act 2006.



577360 mE, 568420 mN

The Property  
Registration Authority  
An tÚdarás  
Clárúcháin Maoine



Folio: CK58009F

This map should be read in conjunction with the folio.

Registry maps are based on OSi topographic mapping. Where registry maps are printed at a scale that is larger than the OSi published scale, accuracy is limited to that of the original OSi map scale.

For details of the terms of use and limitations as to scale, accuracy and other conditions relating to Land Registry maps, see [www.prai.ie](http://www.prai.ie).

This map incorporates Ordnance Survey Ireland (OSi) mapping data under a licence from OSi. Copyright © OSi and Government of Ireland.

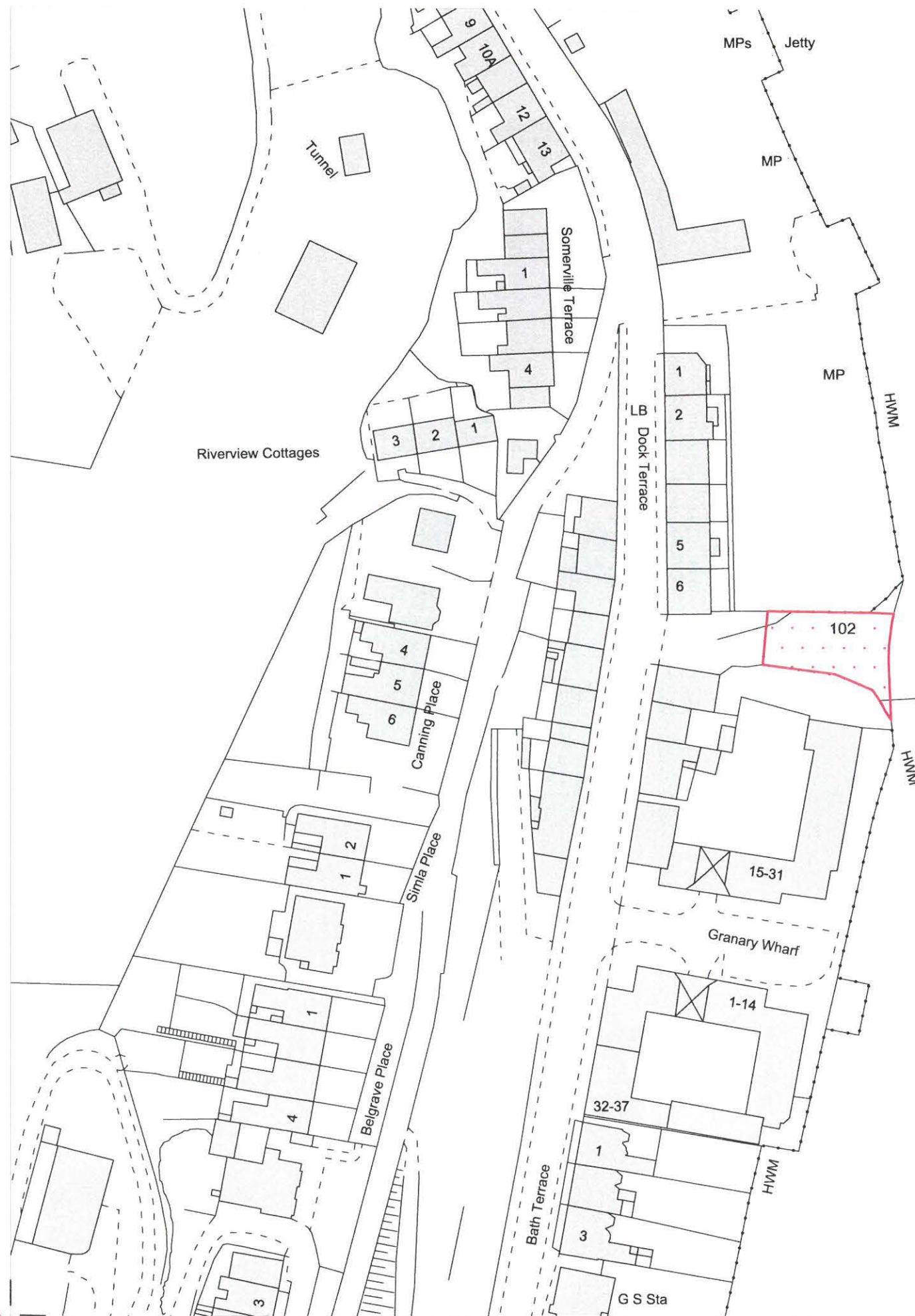

(centre-line of parcel(s) edged)

- Freehold
- Leasehold
- SubLeasehold

Burdens (may not all be represented on map)

- Right of Way / Wayleave
- Turbary
- Pipeline
- Well
- Pump
- Septic Tank
- ▽ Soak Pit

A full list of burdens and their symbology can be found at: [www.landdirect.ie](http://www.landdirect.ie)



The registry operates a non-conclusive boundary system. The Registry Map identifies properties not boundaries meaning neither the description of land in a register nor its identification by reference to a registry map is conclusive as to the boundaries or extent. (see Section 85 of the Registration of Title Act, 1964). As inserted by Section 62 of the Registration of Deed and Title Act 2006.





577140 mE, 568880 mN

The Property  
Registration Authority  
An tÚdarás  
Clárúcháin Maoine



Folio: CK58009F

This map should be read in conjunction with the folio.

Registry maps are based on OSi topographic mapping. Where registry maps are printed at a scale that is larger than the OSi published scale, accuracy is limited to that of the original OSi map scale.

For details of the terms of use and limitations as to scale, accuracy and other conditions relating to Land Registry maps, see [www.prai.ie](http://www.prai.ie).

This map incorporates Ordnance Survey Ireland (OSi) mapping data under a licence from OSi. Copyright © OSi and Government of Ireland.

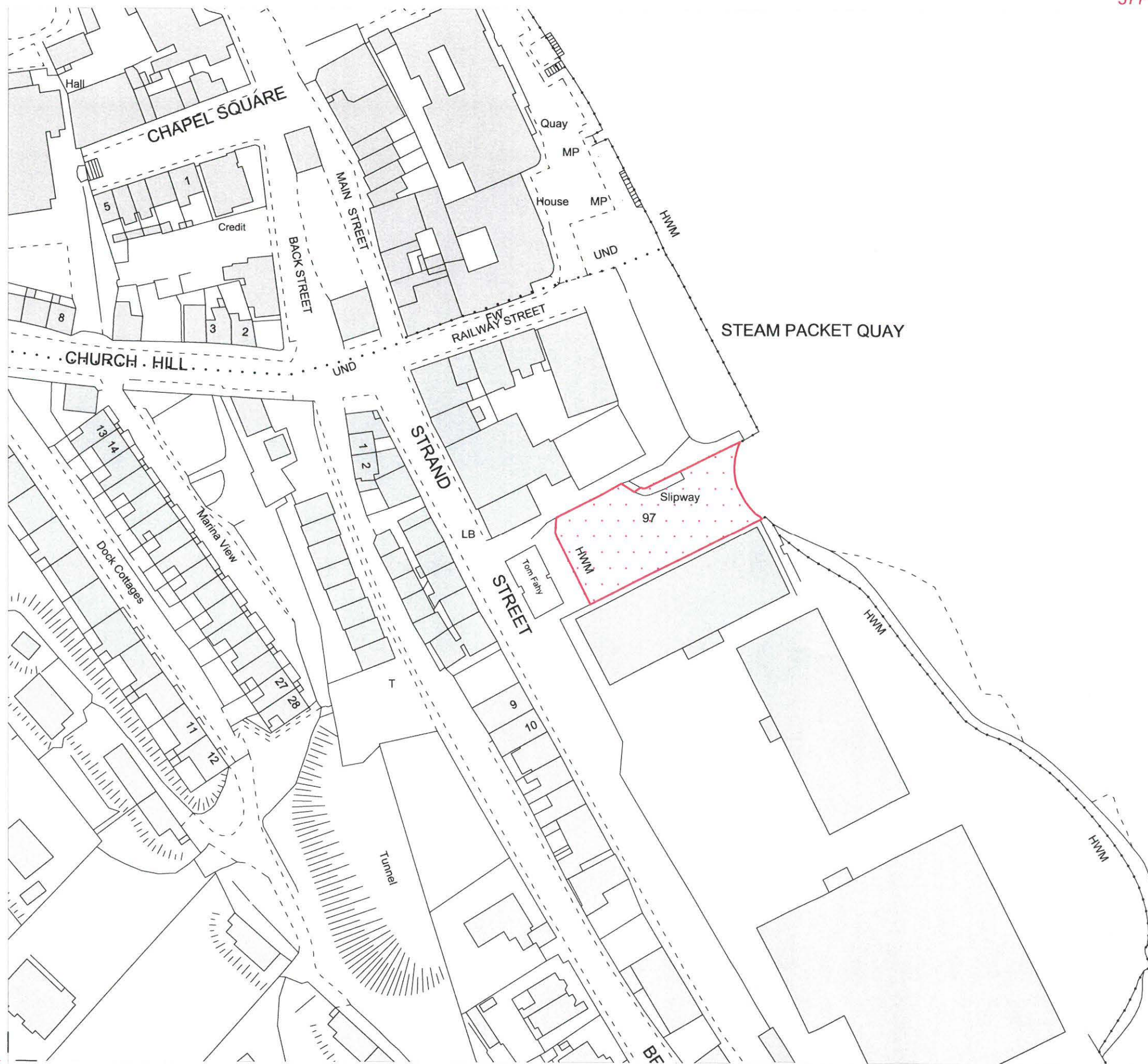

- (centre-line of parcel(s) edged)
- Freehold
- Leasehold
- SubLeasehold

Burdens (may not all be represented on map)

- Right of Way / Wayleave
- Turbary
- Pipeline
- Well
- Pump
- Septic Tank
- Soak Pit

A full list of burdens and their symbology can be found at: [www.landdirect.ie](http://www.landdirect.ie)



The registry operates a non-conclusive boundary system. The Registry Map identifies properties not boundaries meaning neither the description of land in a register nor its identification by reference to a registry map is conclusive as to the boundaries or extent. (see Section 85 of the Registration of Title Act, 1964). As inserted by Section 62 of the Registration of Deed and Title Act 2006.



577200 mE, 568850 mN

**The Property  
Registration Authority  
An tÚdarás  
Clárúcháin Maoine**



Folio: CK58009F

This map should be read in conjunction with the folio.

Registry maps are based on OSi topographic mapping. Where registry maps are printed at a scale that is larger than the OSi published scale, accuracy is limited to that of the original OSi map scale.

For details of the terms of use and limitations as to scale, accuracy and other conditions relating to Land Registry maps, see [www.prai.ie](http://www.prai.ie).

This map incorporates Ordnance Survey Ireland (OSi) mapping data under a licence from OSi. Copyright © OSi and Government of Ireland.

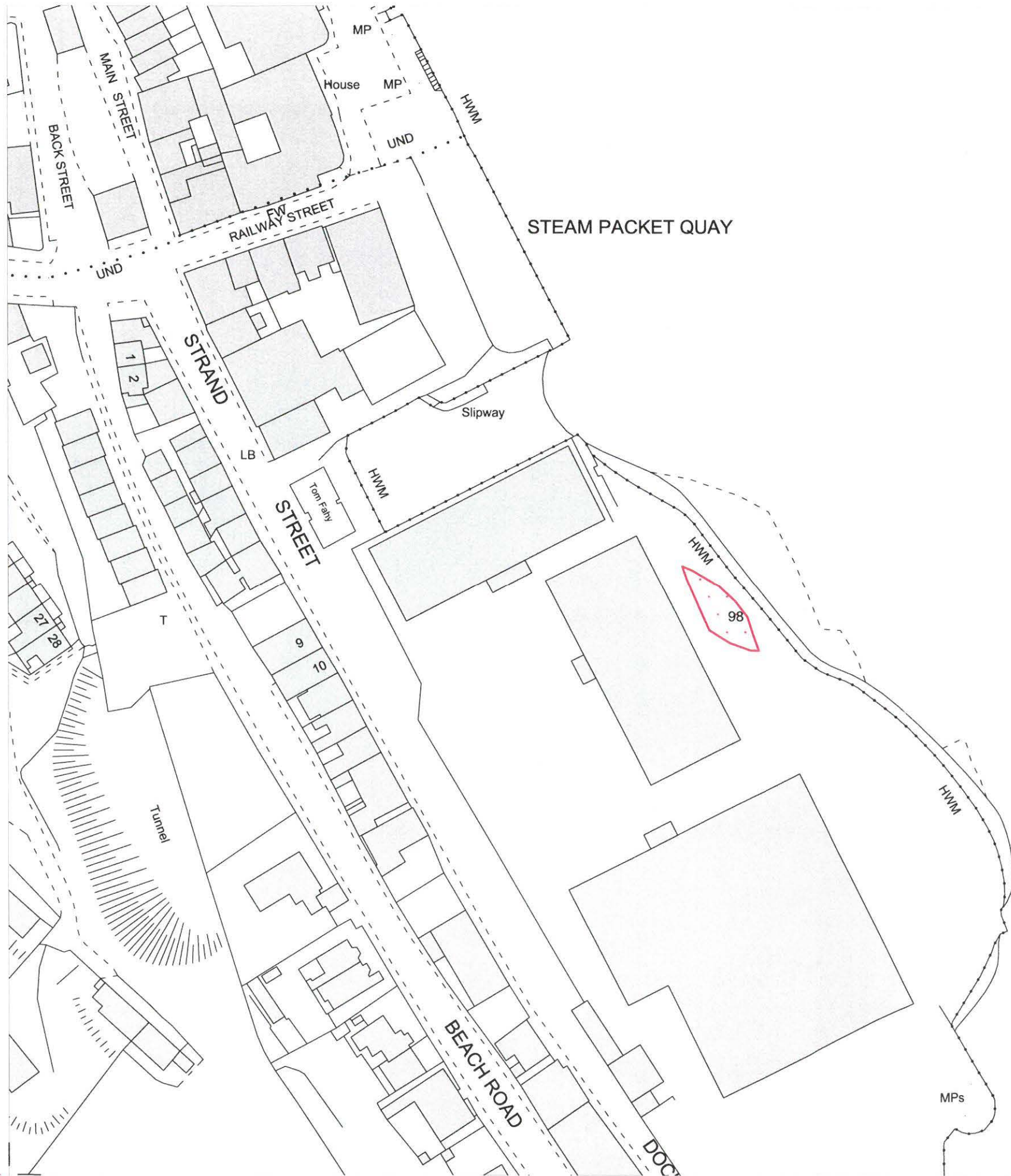

- (centre-line of parcel(s) edged)
- Freehold
- Leasehold
- SubLeasehold

**Burdens** (may not all be represented on map)

- Right of Way / Wayleave
- Turbarry
- Pipeline
- Well
- Pump
- Septic Tank
- ▽ Soak Pit

A full list of burdens and their symbology can be found at: [www.landdirect.ie](http://www.landdirect.ie)



**The registry operates a non-conclusive boundary system. The Registry Map identifies properties not boundaries meaning neither the description of land in a register nor its identification by reference to a registry map is conclusive as to the boundaries or extent.** (see Section 85 of the Registration of Title Act, 1964). As inserted by Section 62 of the Registration of Deed and Title Act 2006.

577240 mE, 568770 mN

The Property  
Registration Authority  
An tÚdarás  
Clárúcháin Maoine



Folio: CK58009F

This map should be read in conjunction with the folio.

Registry maps are based on OSi topographic mapping. Where registry maps are printed at a scale that is larger than the OSi published scale, accuracy is limited to that of the original OSi map scale.

For details of the terms of use and limitations as to scale, accuracy and other conditions relating to Land Registry maps, see [www.prai.ie](http://www.prai.ie).

This map incorporates Ordnance Survey Ireland (OSi) mapping data under a licence from OSi. Copyright © OSi and Government of Ireland.

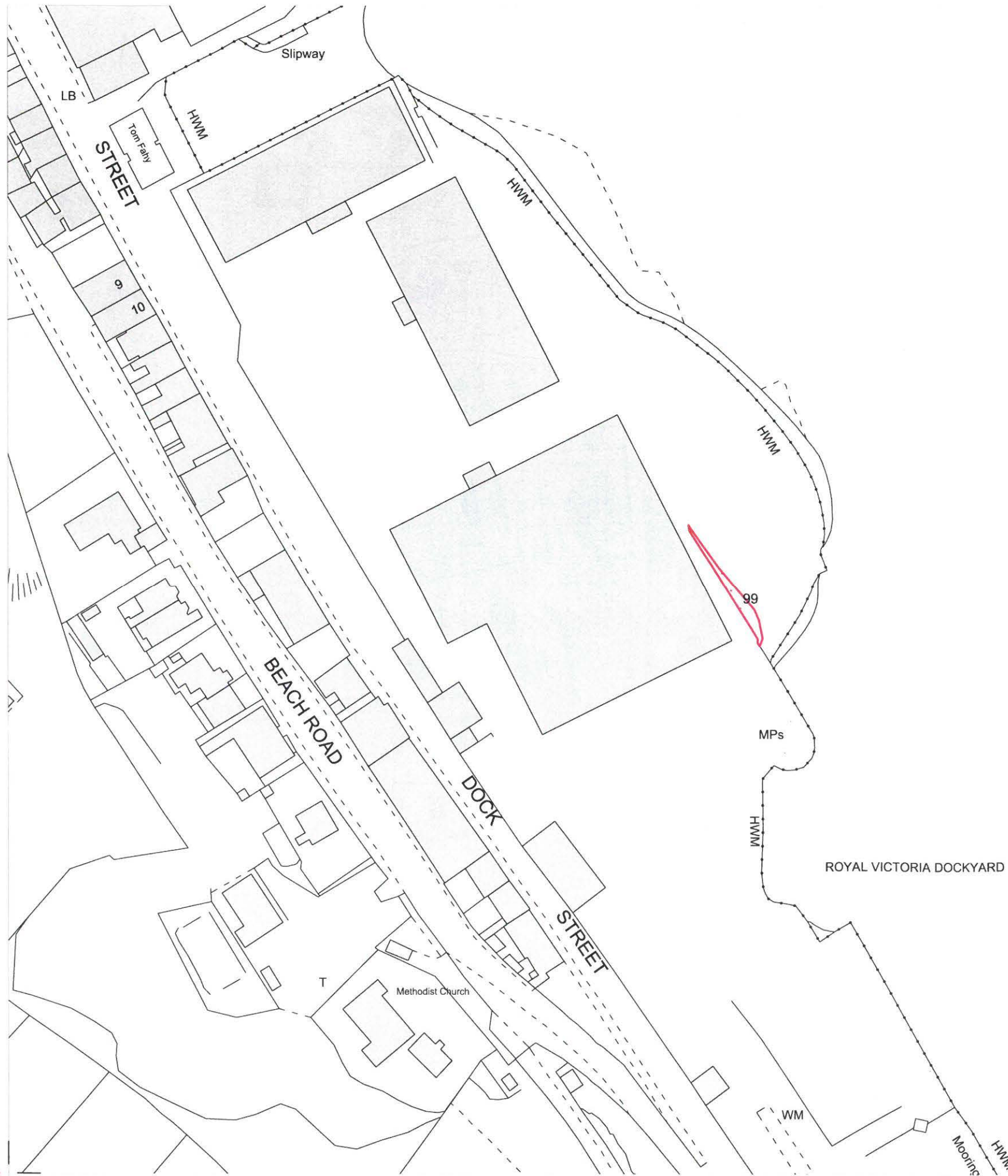

- (centre-line of parcel(s) edged)
- Freehold
- Leasehold
- SubLeasehold

**Burdens** (may not all be represented on map)

- Right of Way / Wayleave
- Turbary
- Pipeline
- Well
- Pump
- Septic Tank
- ▽ Soak Pit

A full list of burdens and their symbology can be found at: [www.landdirect.ie](http://www.landdirect.ie)



The registry operates a non-conclusive boundary system. The Registry Map identifies properties not boundaries meaning neither the description of land in a register nor its identification by reference to a registry map is conclusive as to the boundaries or extent. (see Section 85 of the Registration of Title Act, 1964). As inserted by Section 62 of the Registration of Deed and Title Act 2006.



577500 mE, 567940 mN



**The Property  
Registration Authority  
An tÚdarás  
Clárúcháin Maoine**



Folio: CK58009F

This map should be read in conjunction with the folio.

Registry maps are based on OSi topographic mapping. Where registry maps are printed at a scale that is larger than the OSi published scale, accuracy is limited to that of the original OSi map scale.

For details of the terms of use and limitations as to scale, accuracy and other conditions relating to Land Registry maps, see [www.prai.ie](http://www.prai.ie).

This map incorporates Ordnance Survey Ireland (OSi) mapping data under a licence from OSi. Copyright © OSi and Government of Ireland.

- (centre-line of parcel(s) edged)
  - Freehold
  - Leasehold
  - SubLeasehold
- Burdens** (may not all be represented on map)
- Right of Way / Wayleave
  - Turbarry
  - Pipeline
  - Well
  - Pump
  - Septic Tank
  - ▽ Soak Pit

A full list of burdens and their symbology can be found at: [www.landdirect.ie](http://www.landdirect.ie)



**The registry operates a non-conclusive boundary system. The Registry Map identifies properties not boundaries meaning neither the description of land in a register nor its identification by reference to a registry map is conclusive as to the boundaries or extent.** (see Section 85 of the Registration of Title Act, 1964). As inserted by Section 62 of the Registration of Deed and Title Act 2006.

577530 mE, 567490 mN

The Property  
Registration Authority  
An tÚdarás  
Clárúcháin Maoine



Folio: CK58009F

This map should be read in conjunction with the folio.

Registry maps are based on OSi topographic mapping. Where registry maps are printed at a scale that is larger than the OSi published scale, accuracy is limited to that of the original OSi map scale.

For details of the terms of use and limitations as to scale, accuracy and other conditions relating to Land Registry maps, see [www.prai.ie](http://www.prai.ie).

This map incorporates Ordnance Survey Ireland (OSi) mapping data under a licence from OSi. Copyright © OSi and Government of Ireland.

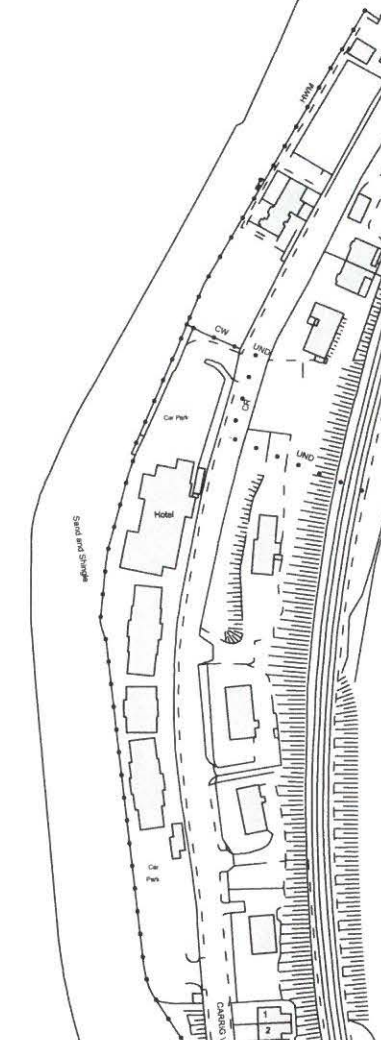

(centre-line of parcel(s) edged)

- Freehold
- Leasehold
- SubLeasehold

Burdens (may not all be represented on map)

- Right of Way / Wayleave
- Turbary
- Pipeline
- Well
- Pump
- Septic Tank
- Soak Pit

A full list of burdens and their symbology can be found at: [www.landdirect.ie](http://www.landdirect.ie)

The registry operates a non-conclusive boundary system. The Registry Map identifies properties not boundaries meaning neither the description of land in a register nor its identification by reference to a registry map is conclusive as to the boundaries or extent. (see Section 85 of the Registration of Title Act, 1964). As inserted by Section 62 of the Registration of Deed and Title Act 2006.



577310 mE, 567040 mN

The Property  
Registration Authority  
An tÚdarás  
Clárúcháin Maoine



Folio: CK58009F

This map should be read in conjunction with the folio.

Registry maps are based on OSi topographic mapping. Where registry maps are printed at a scale that is larger than the OSi published scale, accuracy is limited to that of the original OSi map scale.

For details of the terms of use and limitations as to scale, accuracy and other conditions relating to Land Registry maps, see [www.prai.ie](http://www.prai.ie).

This map incorporates Ordnance Survey Ireland (OSi) mapping data under a licence from OSi. Copyright © OSi and Government of Ireland.

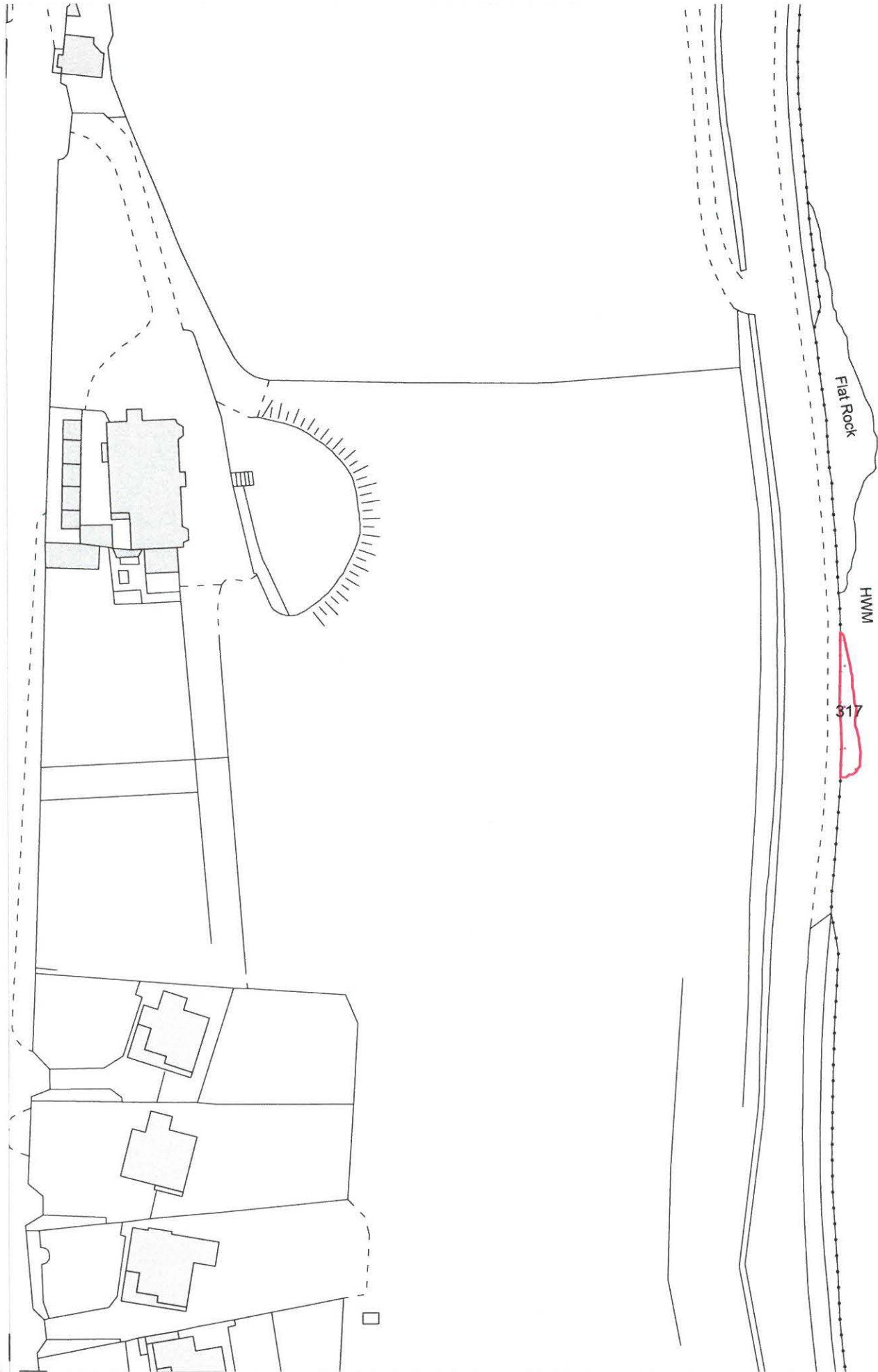

(centre-line of parcel(s) edged)

- Freehold
- Leasehold
- SubLeasehold

Burdens (may not all be represented on map)

- Right of Way / Wayleave
- Turbary
- Pipeline
- Well
- Pump
- Septic Tank
- ▽ Soak Pit

A full list of burdens and their symbology can be found at: [www.landdirect.ie](http://www.landdirect.ie)



The registry operates a non-conclusive boundary system. The Registry Map identifies properties not boundaries meaning neither the description of land in a register nor its identification by reference to a registry map is conclusive as to the boundaries or extent. (see Section 85 of the Registration of Title Act, 1964). As inserted by Section 62 of the Registration of Deed and Title Act 2006.

WEST

576990 mE, 566780 mN  
Date Printed: 02/09/2016

Creation Date: 02 September 2016 16:04:24

Application Number: P2016LR068857W

1:1000 Scale



577310 mE, 566950 mN

The Property  
Registration Authority  
An tÚdarás  
Clárúcháin Maoine



Folio: CK58009F

This map should be read in conjunction with the folio.

Registry maps are based on OSi topographic mapping. Where registry maps are printed at a scale that is larger than the OSi published scale, accuracy is limited to that of the original OSi map scale.

For details of the terms of use and limitations as to scale, accuracy and other conditions relating to Land Registry maps, see [www.prai.ie](http://www.prai.ie).

This map incorporates Ordnance Survey Ireland (OSi) mapping data under a licence from OSi. Copyright © OSi and Government of Ireland.

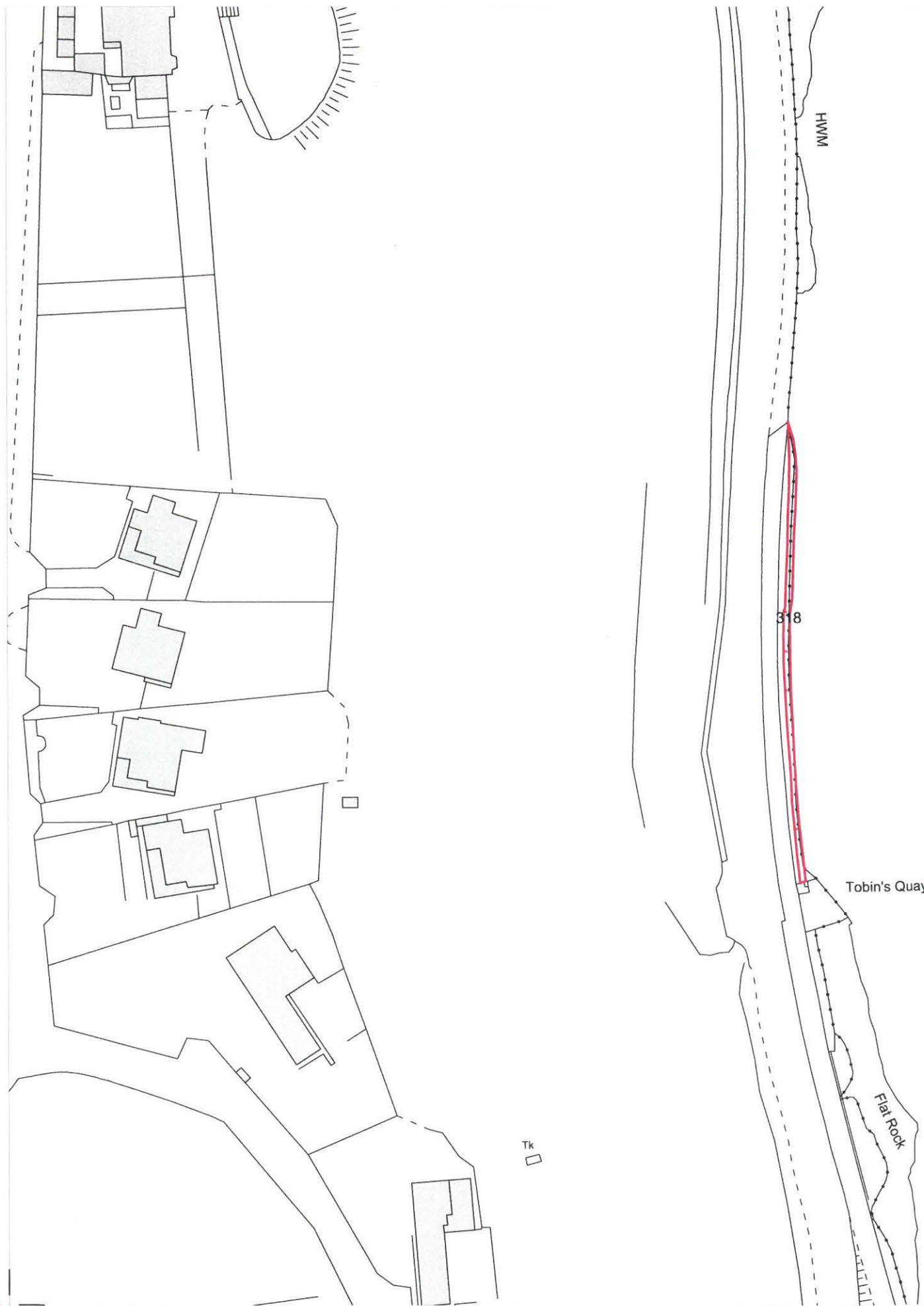

- (centre-line of parcel(s) edged)
- Freehold
- Leasehold
- SubLeasehold

Burdens (may not all be represented on map)

- Right of Way / Wayleave
- Turbary
- Pipeline
- Well
- Pump
- Septic Tank
- ▽ Soak Pit

WEST

A full list of burdens and their symbology can be found at: [www.landdirect.ie](http://www.landdirect.ie)

The registry operates a non-conclusive boundary system. The Registry Map identifies properties not boundaries meaning neither the description of land in a register nor its identification by reference to a registry map is conclusive as to the boundaries or extent. (see Section 85 of the Registration of Title Act, 1964). As inserted by Section 62 of the Registration of Deed and Title Act 2006.



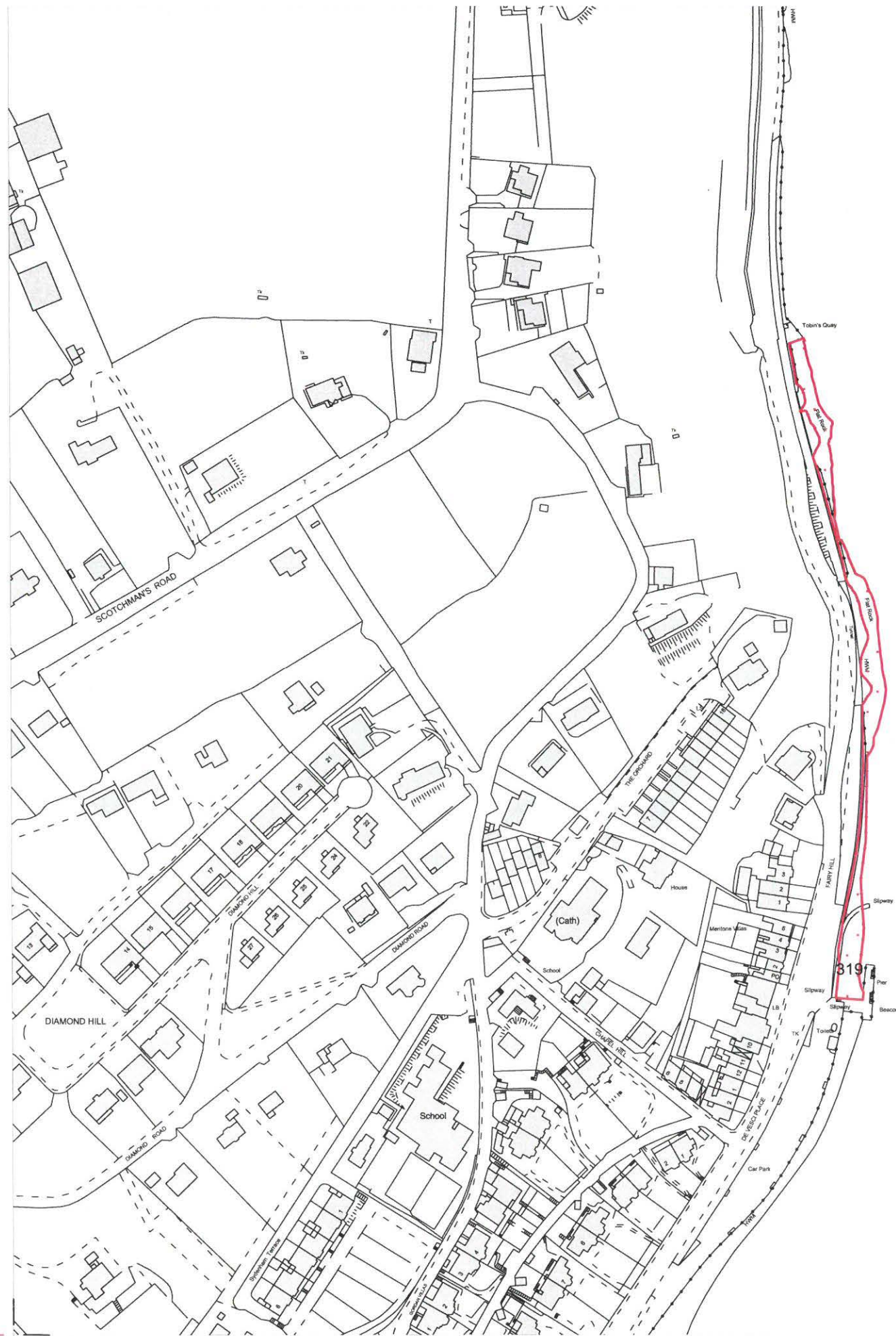

576770 mE, 566280 mN  
Date Printed: 02/09/2016

Creation Date: 02 September 2016 16:03:55

Application Number: P2016LR068857W

577570 mE, 566930 mN



The Property  
Registration Authority  
An tÚdarás  
Clárúcháin Maoine



Folio: CK58009F

This map should be read in conjunction with the folio.

Registry maps are based on OSi topographic mapping. Where registry maps are printed at a scale that is larger than the OSi published scale, accuracy is limited to that of the original OSi map scale.

For details of the terms of use and limitations as to scale, accuracy and other conditions relating to Land Registry maps, see [www.prai.ie](http://www.prai.ie).

This map incorporates Ordnance Survey Ireland (OSi) mapping data under a licence from OSi. Copyright © OSi and Government of Ireland.

- (centre-line of parcel(s) edged)
  - Freehold
  - Leasehold
  - SubLeasehold
- Burdens** (may not all be represented on map)
- Right of Way / Wayleave
  - Turbary
  - Pipeline
  - Well
  - Pump
  - Septic Tank
  - Soak Pit

A full list of burdens and their symbology can be found at: [www.landdirect.ie](http://www.landdirect.ie)



The registry operates a non-conclusive boundary system. The Registry Map identifies properties not boundaries meaning neither the description of land in a register nor its identification by reference to a registry map is conclusive as to the boundaries or extent. (see Section 85 of the Registration of Title Act, 1964). As inserted by Section 62 of the Registration of Deed and Title Act 2006.



577280 mE, 566460 mN

The Property  
Registration Authority  
An tÚdarás  
Clárúcháin Maoine



Folio: CK58009F

This map should be read in conjunction with the folio.

Registry maps are based on OSi topographic mapping. Where registry maps are printed at a scale that is larger than the OSi published scale, accuracy is limited to that of the original OSi map scale.

For details of the terms of use and limitations as to scale, accuracy and other conditions relating to Land Registry maps, see [www.prai.ie](http://www.prai.ie).

This map incorporates Ordnance Survey Ireland (OSi) mapping data under a licence from OSi. Copyright © OSi and Government of Ireland.

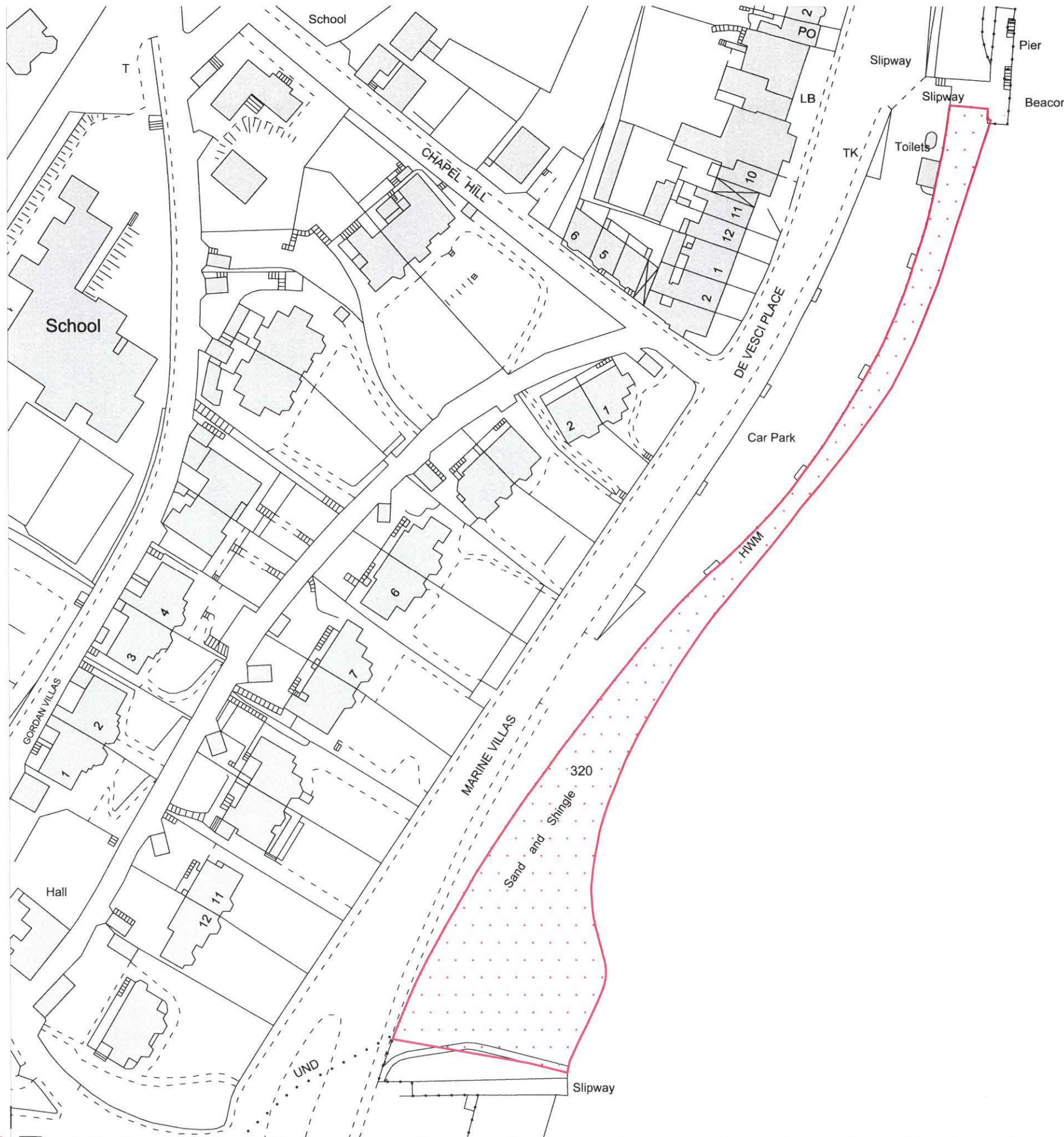

(centre-line of parcel(s) edged)

- Freehold
- Leasehold
- SubLeasehold

Burdens (may not all be represented on map)

- Right of Way / Wayleave
- Turbary
- Pipeline
- Well
- Pump
- Septic Tank
- Soak Pit

A full list of burdens and their symbology can be found at: [www.landdirect.ie](http://www.landdirect.ie)



The registry operates a non-conclusive boundary system. The Registry Map identifies properties not boundaries meaning neither the description of land in a register nor its identification by reference to a registry map is conclusive as to the boundaries or extent. (see Section 85 of the Registration of Title Act, 1964). As inserted by Section 62 of the Registration of Deed and Title Act 2006.



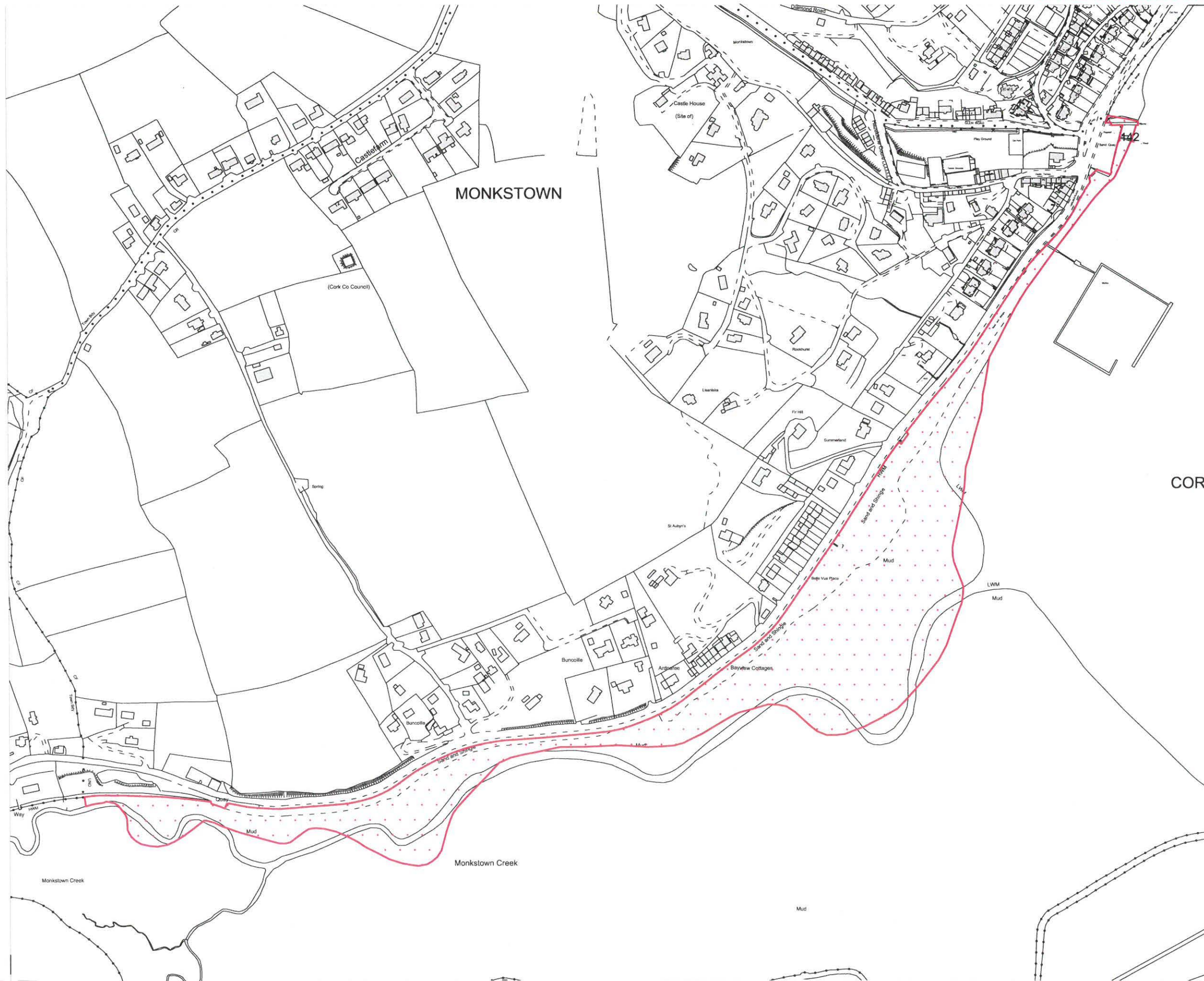

**The Property  
Registration Authority  
An tÚdarás  
Clárúcháin Maoine**



Folio: CK58009F

This map should be read in conjunction with the folio.

Registry maps are based on OSi topographic mapping. Where registry maps are printed at a scale that is larger than the OSi published scale, accuracy is limited to that of the original OSi map scale.

For details of the terms of use and limitations as to scale, accuracy and other conditions relating to Land Registry maps, see [www.prai.ie](http://www.prai.ie).

This map incorporates Ordnance Survey Ireland (OSi) mapping data under a licence from OSi. Copyright © OSi and Government of Ireland.

- (centre-line of parcel(s) edged)
- Freehold
- Leasehold
- SubLeasehold

**Burdens** (may not all be represented on map)

- Right of Way / Wayleave
- Turbary
- Pipeline
- Well
- Pump
- Septic Tank
- ▭ Soak Pit

A full list of burdens and their symbology can be found at: [www.landdirect.ie](http://www.landdirect.ie)

**The registry operates a non-conclusive boundary system. The Registry Map identifies properties not boundaries meaning neither the description of land in a register nor its identification by reference to a registry map is conclusive as to the boundaries or extent.** (see Section 85 of the Registration of Title Act, 1964). As inserted by Section 62 of the Registration of Deed and Title Act 2006.



575930 mE, 565550 mN

The Property  
Registration Authority  
An tÚdarás  
Clárúcháin Maoin



Folio: CK58009F

This map should be read in conjunction with the folio.

Registry maps are based on OSi topographic mapping. Where registry maps are printed at a scale that is larger than the OSi published scale, accuracy is limited to that of the original OSi map scale.

For details of the terms of use and limitations as to scale, accuracy and other conditions relating to Land Registry maps, see [www.prai.ie](http://www.prai.ie).

This map incorporates Ordnance Survey Ireland (OSi) mapping data under a licence from OSi. Copyright © OSi and Government of Ireland.

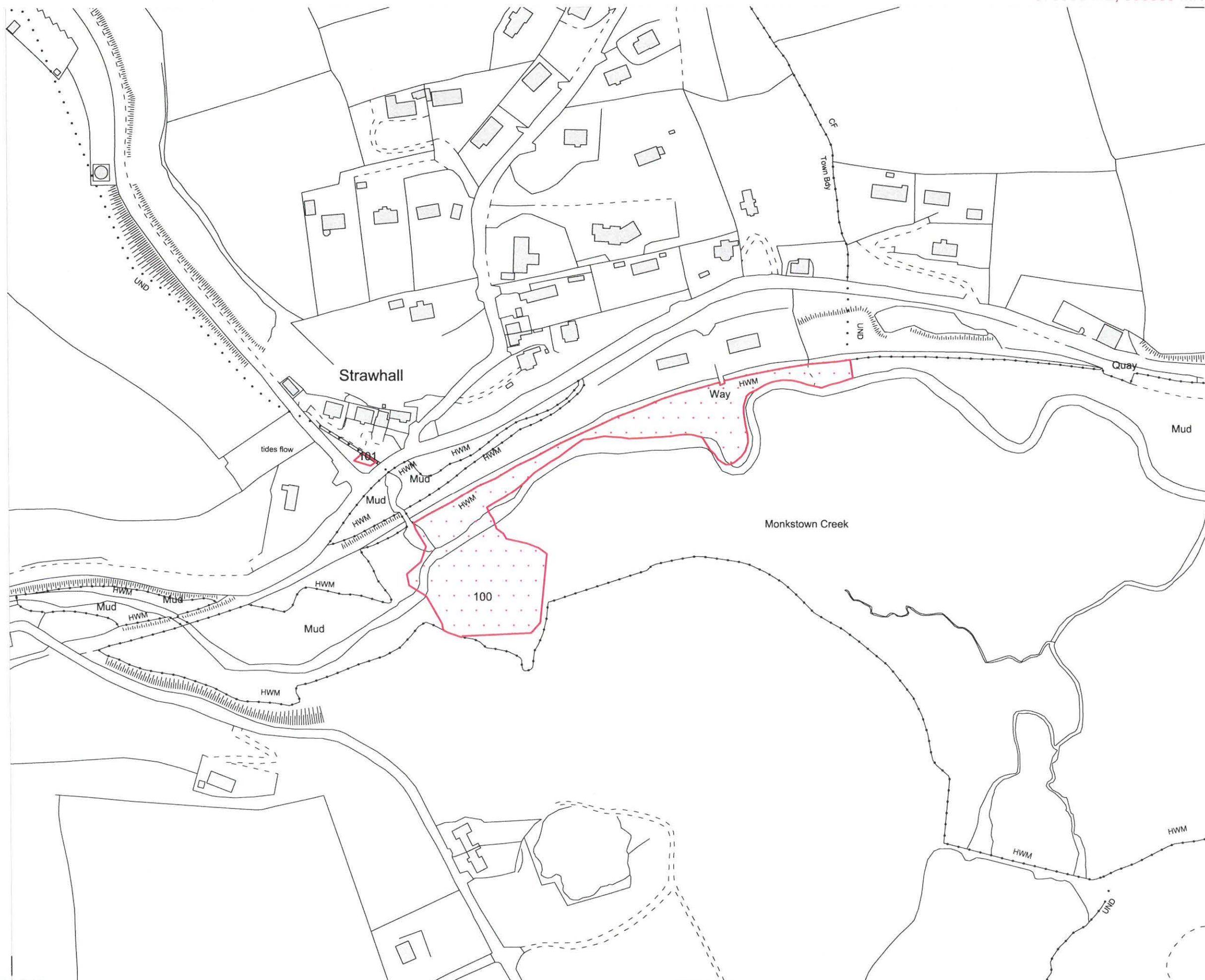

- (centre-line of parcel(s) edged)
- Freehold
- Leasehold
- SubLeasehold

Burdens (may not all be represented on map)

- Right of Way / Wayleave
- Turbary
- Pipeline
- Well
- Pump
- Septic Tank
- Soak Pit

A full list of burdens and their symbology can be found at: [www.landdirect.ie](http://www.landdirect.ie)

The registry operates a non-conclusive boundary system. The Registry Map identifies properties not boundaries meaning neither the description of land in a register nor its identification by reference to a registry map is conclusive as to the boundaries or extent. (see Section 85 of the Registration of Title Act, 1964). As inserted by Section 62 of the Registration of Deed and Title Act 2006.

